



**GRAMMER**  
Ersatzteilzeichnung  
SPARE PARTS DRAWING

MSG 65-01

Sammelzeichnung

COLLECTIVE DRAWING  
Zutreffende Positionen  
siehe Ersatzteilliste !

CORRESPONDING POSITIONS  
SEE SPARE PARTS LIST !

Stand: 10.07.2014  
LEVEL:

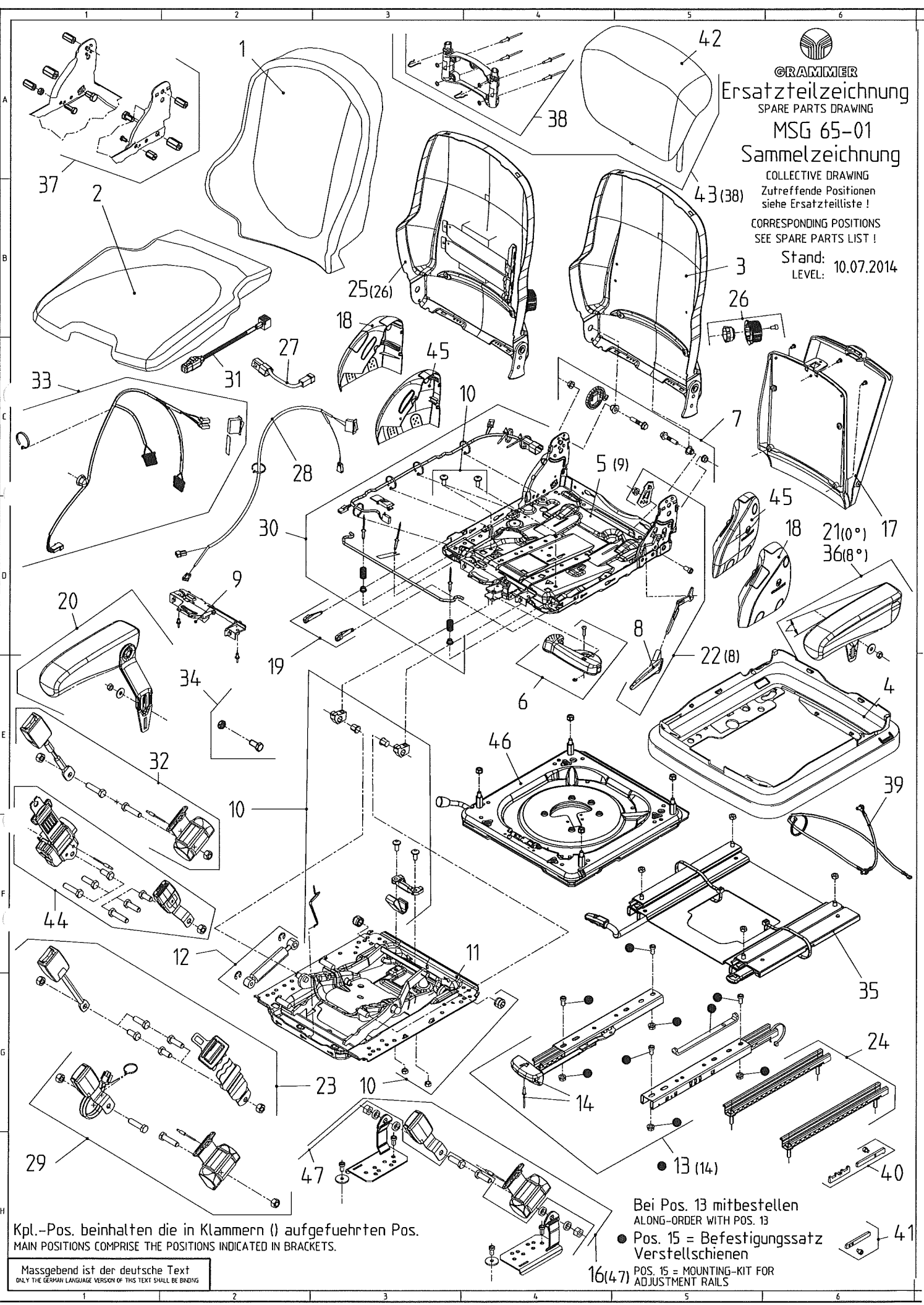

Kpl.-Pos. beinhalten die in Klammern () aufgeführten Pos.  
MAIN POSITIONS COMPRISE THE POSITIONS INDICATED IN BRACKETS.

Massgebend ist der deutsche Text  
ONLY THE GERMAN LANGUAGE VERSION OF THIS TEXT SHALL BE BINDING

Bei Pos. 13 mitbestellen  
ALONG-ORDER WITH POS. 13

● Pos. 15 = Befestigungssatz  
Verstellschienen

16(47) POS. 15 = MOUNTING-KIT FOR  
ADJUSTMENT RAILS

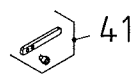

Partslist    MSG65-01/1106231                      SPARE PARTS LIST FOR SEAT  
 Cust.Mat-No.                      1106232

Drawing-No: MSG65-01

Pos	Id.-No.	Description	Qty.	Werkstoff Norm	Cu-Mat.-No.
1	1093670	BACKREST CUSHION <i>Gelen</i>	1		
1	1106478	BACKREST CUSHION <i>Tyg</i>	1		
2	1093662	SEAT CUSHION <i>Gelen</i>	1	/	
				/	
2	<i>1117617</i>	SEAT CUSHION <i>Tyg</i>	1	/	
				/	
4	1079665	BELLOWS CPL.	1	/	
				/	
5	1079669	SUSPENSION MSG65	1		
6	1081425	HANDLE KIT,GREY, FOR	1		
7	1079661	BACKREST BEARING CPL	1	/	
8	1071081	GRIP F. BACK ANGLE A	1		
9	1263761	HOUSING KIT	1		
10	1100341	SET OF WEAR PARTS MS	1	/	
				-	
11	1079664	SWING ARM KIT	1		
12	1081800	SHOCK ABSORBER CPL.	1	/	
13	1079673	SET OF ADJUSTMENT RA	1		
14	1081426	HANDLE KIT,GREY	1		
15	1094132	ASSEMBLY PARTS KIT F	1	/	
16	1100340	Restraint System	1		
17	1094723	POCKET CPL.	1	/	
				-	
18	1081375	COVERS CPL.	1	/	
				/	
20	1079670	ARMREST KIT,A60/320,	1		
21	1079671	ARMREST KIT,A60/320,	1		
22	1105461	BACKREST ADJUSTMENT	1	/	
				/	
25	1097731	BACKREST CPL.	1	/	
26	1081761	HANDLE KIT,GREY, FOR	1		
27	1124997	ADAPTER CABLE KIT	1		
28	1104792	SEAT HEAT KIT,SERIES	1		
28	1104793	SEAT HEAT KIT,PARALL	1		
29	1123422	RESTRAINT SYSTEM,LS,	1		
30	1104948	SWITCH KIT-no ass	1		